



# Console Layout & Navigation

Tafonic Quick Start Guide

# Introduction

- The Tafonic Platform Console provides a simple web-interface for the Tafonic platform. It can be used to manage your Tafonic account and access various features offered by the platform.
- This document describes the general layout and organization of the platform console and the means for navigating its different sections.

## Note:

The internal sections of the console are only meant for registered users of the Tafonic platform. You cannot access them unless you have (successfully) signed in.

# Members Page

- The Members page provides access to the Tenant Member Directory, which maintains the list of all the members of your tenant.
- You can go to this page to lookup the 'public user profile' of any member belonging to your tenant.
- This service is provided to let members network and communicate (e.g. share application instances) with each other.

# App Library Page

- The App Library page provides access to your tenant's App Library.
- On this page, you will be able to lookup and find all the applications that are available for you to use.
- Summarized information about each application is displayed on a separate card.
- If you click on an application card, you will be taken to the application detail page, which contains additional information about that particular application.
  - The application detail page also provides the necessary controls for creating an instance of the application.

# App Instances Page

- The App Instances page lists all the application instances that you own.
- These application instances were either created by you or were transferred to you by other members.
- Summarized information about each application instance is displayed on a separate card.
- If you click on an application instance card, you will be taken to the application instance detail page, which contains additional information about that particular application instance.
  - The application instance detail page also provides the necessary controls for managing the application instance.

# Interfaces Page

- The Interfaces page lists all the interfaces for which you are the operator.
- These interfaces are either owned by you or have been assigned to you by other members.
- Summarized information about each interface is displayed on a separate card.
- If you click on an interface card, you will be taken to the interface detail page, which contains additional information about that particular interface.
  - The interface detail page also provides the necessary controls for managing/operating the interface.

# Settings Page

- The Settings page displays your user profile card.
- The user profile card is made up of two sections.
  - Public Profile:  
Contains information that is visible to other members of your tenant.
  - Private Profile:  
Contains information that is only visible to you (and the system/tenant administrators).
- This page also provides controls for:
  - Editing your public profile.
  - Changing your email address.
  - Changing your password.

# Main Menu

- The main menu used for navigating to important sections of the platform console can appear in one of two forms, depending on the width of the browser window.
- On desktop computers, laptops or large tablets, where the browser window can be made sufficiently wide, a top navigation bar will serve as the main menu.
  - The top navigation bar is displayed in the header section of the platform console.

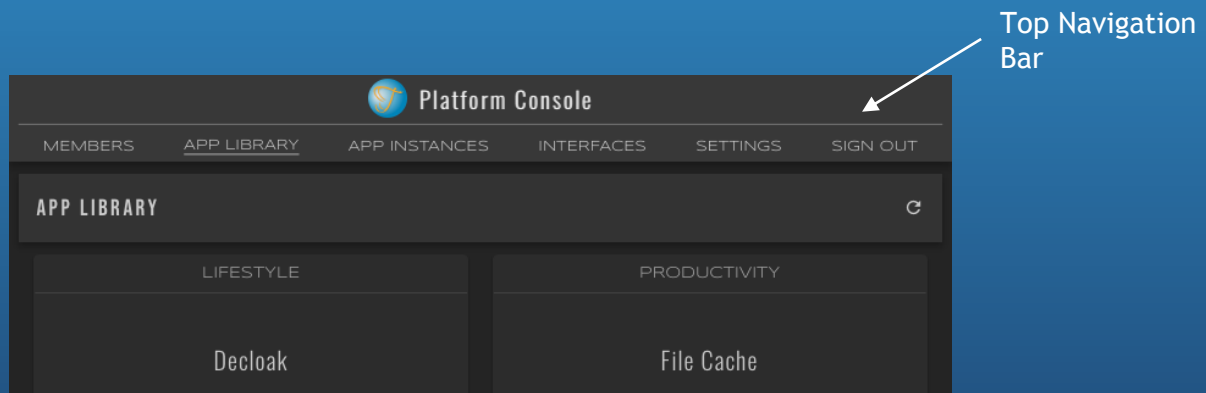



# Main Menu

- If the browser window is very narrow (common on small tablets and mobile phones), a side navigation bar will serve as the main menu.
  - The side navigation bar is normally hidden to conserve screen real estate.

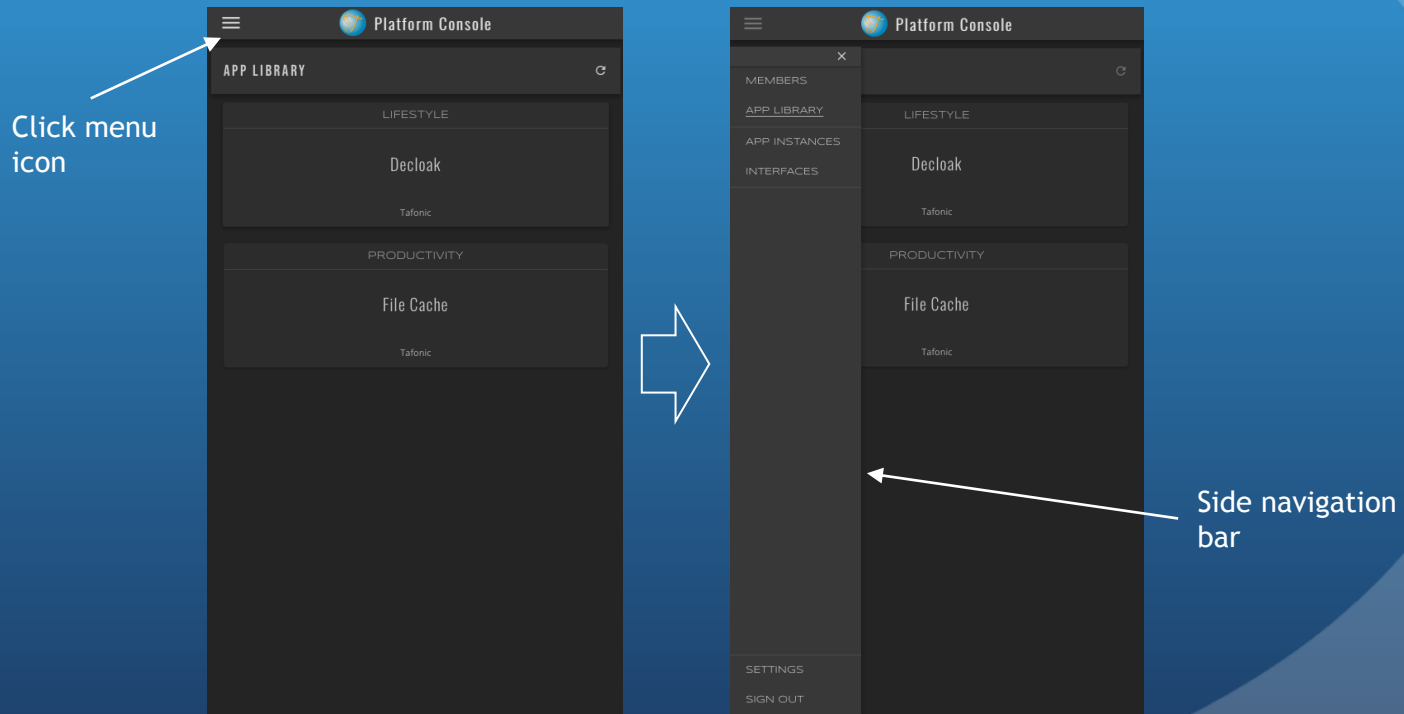

Copyright 2024 Tafonic LLC. All rights reserved.

[www.tafonic.com](http://www.tafonic.com)